

# Important Safety Instructions

1. Read these instructions.
2. Keep these instructions.
3. Heed all warnings.
4. Follow all instructions.
5. Do not use this apparatus near water.
6. Clean only with dry cloth.
7. Do not block any ventilation openings. Install in accordance with the manufacturer's instructions.
8. Do not install near any heat sources such as radiators, heat registers, stoves, or other apparatus (including amplifiers) that produce heat.
9. Do not defeat the safety purpose of the polarized or grounding-type plug. A polarized plug has two blades with one wider than the other. A grounding type plug has two blades and a third grounding prong. The wide blade or the third prong are provided for your safety. If the provided plug does not fit into your outlet, consult an electrician for replacement of the obsolete outlet.
10. Protect the power cord from being walked on or pinched particularly at plugs, convenience receptacles, and the point where they exit from the apparatus.
11. Only use attachments / accessories specified by the manufacturer.
12. Use only with the cart, stand, tripod, bracket, or table specified by the manufacturer, or sold with the apparatus. When a cart is used, use caution when moving the cart / apparatus combination to avoid injury from tip-over.
13. Unplug this apparatus during lightning storms or when unused for long periods of time.
14. Refer all servicing to qualified service personnel. Servicing is required when the apparatus has been damaged in any way, such as power-supply cord or plug is damaged, liquid has been spilled or objects have fallen into the apparatus, the apparatus has been exposed to rain or moisture, does not operate normally, or has been dropped.
15. **WARNING:** To Reduce The Risk Of Fire Or Electric Shock, Do Not Expose This Apparatus To Rain Or Moisture.
16. Apparatus shall not be exposed to dripping or splashing and no objects filled with liquids, such as vases, shall be placed on the apparatus.
17. The mains plug is used as the disconnect and shall remain readily operable.
18. This TV is not designed for outdoors installation. Do not expose the TV to rain, as it may result in a fire or an electric shock. Also, do not expose the TV to direct sunlight, as it may heat up and become damaged.



CAUTION: RISK OF ELECTRIC SHOCK DO NOT OPEN.

AVIS: RISQUE DE CHOC ELECTRIQUE-NE PAS OUVRIR.



## Safety:

TO REDUCE THE RISK OF ELECTRICAL SHOCK DO NOT REMOVE COVER (OR BACK). NO USER SERVICEABLE PARTS ARE INSIDE. REFER TO QUALIFIED SERVICE TECHNICIAN ONLY.



**Dangerous Voltage:** The lightning flash with arrowhead symbol, within an equilateral triangle, is intended to alert the user to the presence of uninsulated "dangerous voltage" within the product's enclosure that may be of sufficient magnitude to constitute a risk of electric shock to the users.



**Instruction:** The exclamation point within an equilateral triangle is intended to alert the user to the presence of important operating and servicing instructions in the literature accompanying the appliance.

# Safety Instructions

Please read these instructions carefully.

This product complies with all applicable US federal safety requirements, as well as those of the Canadian Standards Association.

## **1. Cleaning**

Always unplug the TV before cleaning. Do not use liquid or aerosol cleaners. Use a soft, slightly damp cloth to clean.

## **2. Water and Moisture**

Do not use this TV near water. Avoid using this TV in an excessively damp environment.

## **3. Stand**

This TV should always be placed on a solid, sturdy surface.

## **4. Ventilation**

To prevent overheating, do not block or obstruct the vent openings on the TV's back panel. Also, avoid placing this TV in a confined area with poor air flow.

## **5. Power Sources**

This TV should be operated only from the type of power source indicated on the marking label. If you are not sure of the type of power supply to your home, consult your electronics retailer or local power company.

## **6. Power Cord Polarization**

This TV is equipped with a three-wire grounding type plug, a plug with a third (grounding) pin. As a safety feature, this plug will only fit into a grounded power outlet. If you are unable to insert the plug into the outlet, contact your electrician to replace the obsolete outlet. Do not defeat the safety purpose of the grounding-type plug.

## **7. Power Cord Protection**

Power-supply cords should be routed so that they are not likely to be walked on or pinched by items placed upon or against them. Pay particular attention to cords at plugs, convenience receptacles, and the point where they exit from the TV.

## **8. Lightning**

To protect the TV during a lightning storm, or when it is left unattended and unused for long periods of time, unplug it from the wall outlet and disconnect the antenna or cable system. This will prevent damage to the TV from lightning and power-line surges.

# Safety Instructions

## 9. Outdoor Antenna Grounding

If an outside antenna or cable system is connected to the TV be sure the antenna or cable system is grounded so as to provide some protection against voltage surges and built up static charges. Article 810 of the National Electrical Code (U.S. A.), ANSI / NFPA 70 provides information with regard to proper grounding of the mast and supporting structure, grounding of the lead-in wire to an antenna discharge unit, size of grounding conductors, location of antenna-discharge unit, connection to grounding electrodes, and requirements for the grounding electrode.

*Example of Grounding According to National Electrical Code Instructions*

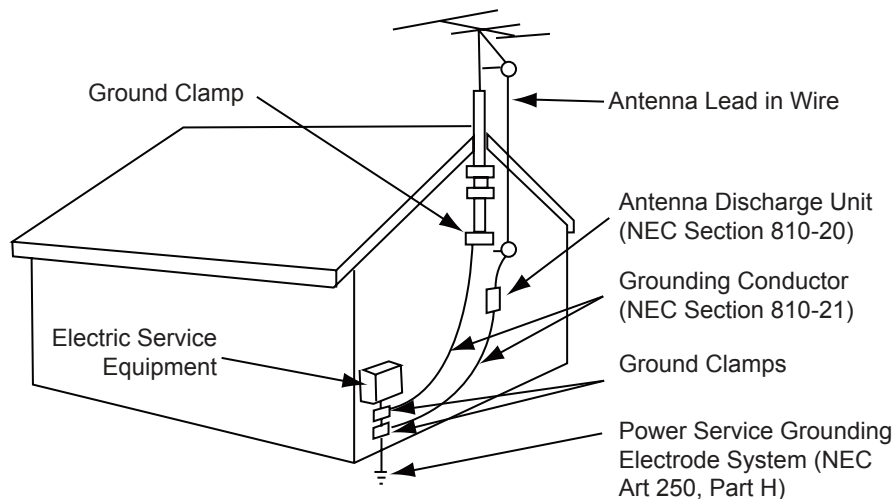

NEC - National Electrical Code

## 10. Power Lines

An outside antenna system should not be located in the vicinity of overhead power lines or other electric light or power circuits, or where it can fall on to power lines or circuits. When installing an outside antenna system, extreme care should be taken to keep from touching such power lines or circuits as contact with them might be fatal.

## 11. Overloading

Do not overload wall outlets and extension cords as this can result in a risk of fire or electric shock.

## 12. Object and Liquid Entry

Never push objects of any kind into this TV through openings as they may touch dangerous voltage points or short-out parts that could result in a fire or electric shock. Never spill liquid of any kind on or inside the TV.

## 13. Servicing

Do not attempt to service this TV yourself as opening or removing covers may expose you to dangerous voltage or other hazards. Refer all servicing to a qualified service technician.

## 14. Damage Requiring Service

Unplug from the wall outlet and refer servicing to a qualified service technician under the following conditions:

- If the power-supply cord or plug is damaged.
- If liquid has been spilled, or objects have fallen into the product.
- If the TV has been exposed to rain or water.
- If the TV does not operate normally by following the operating instructions. Adjust only those controls that are covered by the operating instructions as an improper adjustment of other controls may result in damage and will often require extensive work by a qualified technician to restore the product to its normal operation.
- If the TV has been dropped or the cabinet has been damaged.
- If the TV exhibits a distinct change in performance.

## 15. Replacement Parts

When replacement parts are required, be sure that only an authorized service technician has used replacement parts specified by the manufacturer or have the same characteristics as the original part. Unauthorized substitutions may result in fire, electric shock, or other hazards and void any warranty.

# Safety Instructions

## 16. Safety Check

Upon completion of any service or repairs to this TV, ask the service technician to perform safety checks to determine whether the product is in proper operating condition.

## 17. Wall Mounting

The TV should be mounted to a wall only by a professional. The TV may slide or fall, causing serious injury to a child or adult, and serious damage to the product. Warranty shall be voided.

Wall hanging height of the whole machine shall not exceed 2m.

Machines need to be mounted on rigid surfaces such as cement or concrete.

## 18. Heat

The TV should be situated away from heat sources such as radiators, heat registers, stoves, or other products (including amplifiers) that produce heat.

## 19. Remote Control

Do not expose the remote control to liquids, direct sunlight or sources of excessive heat.

## NOTE TO CABLE / TV INSTALLER:

This reminder is provided to call the CATV system installer's attention to Article 820-40 of the National Electric Code (USA). The code provides guidelines for proper grounding and, in particular, specifies that the cable ground should be connected to the grounding system of the building, as close to the point of the cable entry as practical.

## FCC REGULATORY INFORMATION:

This television has been tested and found to comply with the limits for a Class B digital device, pursuant to Part 15 of the FCC Rules. These limits are designed to provide reasonable protection against harmful interference in a residential installation. This television generates, uses and can radiate radio frequency energy and, if not installed and used in accordance with the instructions, may cause harmful interference to radio communications. However, there is no guarantee that interference will not occur in a particular installation. If this television does cause interference to other electronic equipment, which can be determined by turning the television off and on, then the user is encouraged to try to correct the interference by one or more of the following measures:

- Reorient or relocate the receiving antenna.
- Increase the separation between the equipment and television.
- Connect the equipment into an outlet on a circuit different from that to which the television is connected.
- Consult your dealer or an experienced radio / TV technician for assistance.

Any changes or modifications not expressly approved by the party responsible for compliance may void the user's authority to operate the equipment.

### Stability Hazard

Never place a television set in an unstable location. A television set may fall, causing serious personal injury or death. Many injuries, particularly to children, can be avoided by taking simple precautions such as:

- Using cabinets or stands recommended by the manufacturer of the television set.
- Only using furniture that can safely support the television set.
- Ensuring the television set is not overhanging the edge of the supporting furniture.
- Not placing the television set on tall furniture (for example, cupboards or bookcases) without anchoring both the furniture and the television set to a suitable support.
- Not placing the television set on cloth or other materials that may be located between the television set and supporting furniture.
- Educating children about the dangers of climbing on furniture to reach the television set or its controls.

If your existing television set is being retained and relocated, the same considerations as above should be applied.

-  This equipment is a Class II or double insulated electrical appliance. It has been designed in such a way that it does not require a safety connection to electrical earth.



# Table of Contents

Important Safety Instructions.....	1
Table of Contents .....	5
Introduction.....	6
<b>Remote Control</b>	
Battery Install.....	7
Overview .....	8
<b>TV Overview</b>	
Front Panel.....	10
Rear Panel.....	11
Connecting External Devices .....	12
<b>TV Settings</b> .....	13
<b>Media</b> .....	30
<b>Specifications</b> .....	33
<b>Troubleshooting</b> .....	34

# Introduction

## What's In The Box

Thank you for purchasing the energy efficient LES50F52 television. It has been designed to enjoy today's high definition television experience. With a display resolution of 50"1920X1080 you are assured of one of the finest quality televisions available today.

Your television provides both analog and digital inputs including one (1) High Definition Multimedia Interface (HDMI) interconnects for the purest audio and video digital signal when connected to compatible HD sources (ie: HD set-top box, high definition DVD player or gaming console).

We recommend that you read the user manual thoroughly before use to familiarize yourself with the installation and adjustment options available to you; thereby, enjoying all the features of the LES50F52 for many years to come.

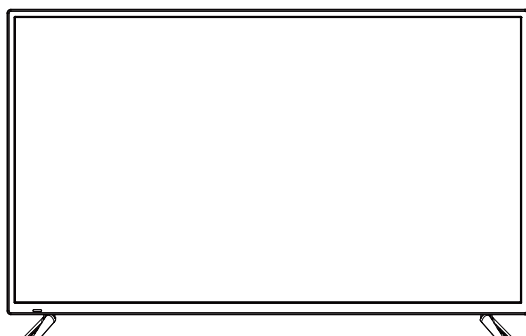

The LES50F52 package includes the following items.

- **Remote Control**
- **AAA Batteries (2)**
- **Quick Start Guide**
- **User Manual**
- **Warranty Card**
- **Audio Cable**



- Remote Control
- AAA Batteries x 2



- User manual
- Quick Start Guide



- Audio Cable

## Wall Mount Information

This TV uses a 400x200 VESA mounting bracket attachment pattern. Please take this information with you when purchasing a wall mount for this TV.

# Remote Control

## Battery Install

**Your remote control handset is powered by two (2) AAA type batteries**



- To insert the batteries, turn the remote control over and remove the battery cover.



- Place two (2) "AAA" batteries into the battery compartment with the "+" and "-" ends facing the correct way as shown in the battery compartment.



- Replace the cover

- When pointed towards the television, the effective range of the remote is approximately 16 feet from the front of the TV IR receiver and at an angle of no greater than 30° to the left / right or 20° up / down.
- To avoid possible damage from battery chemical leakage, remove the batteries if you do not plan to use the remote control for an extended period of time. Do not mix batteries of different age and / or type. Always discard used batteries safely.
- Do not expose the remote control to liquids, direct sunlight or sources of excessive heat.
- The IR receiver on the TV will not work properly if the set is in direct sunlight or an object is in the path between the remote control and the IR receiver on the front of the TV.

**NOTE:** Improper use of batteries can result in a chemical leakage or explosion.

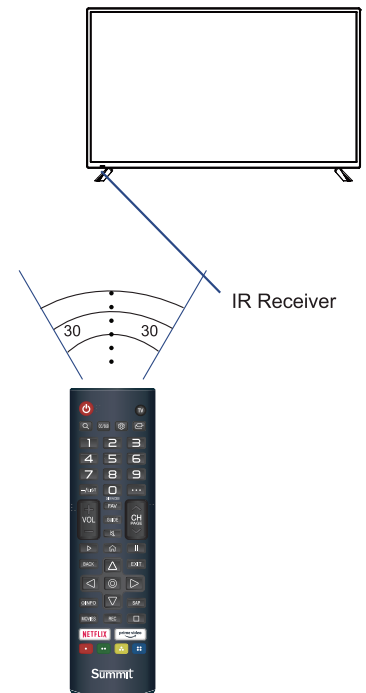

POWER : ON/OFF.

TV : Switch to TV.

Q : Search.

CC : Closed Caption selection:ON/OFF/CC On Mute.

SUB : Enable/disable subtitles.

⚙️ : Enters the Quick Settings menu.

📺 : Selects an input source.

0-9 : Number selection key.

— : Enter multiple program channel number such as 2-1.

LIST : The QUICK ACCESS edit screen appears.

... : It displays the additional buttons on the remote control.

VOL+/- : It adjusts the volume level.

CH PAGE ^/▼ : You can change the programme.

FAV : Press to display a listing of your favorite TV channels.

GUIDE : You can check the programme.

🔇 : Mutes the sound.

▶ : Play.

🏠 : Displays the Home menu.

⏸ : Pause.

BACK : Move to the previous step.

EXIT : Closes the menu.

⦿ : Select current option that's highlighted.

△▽◀▶ : RIGHT/LEFT UP/DOWN buttons to navigate the on-screen menus.

INFO : Press to display the source and channels display.

SAP : Audio Language.

MOVIES : Search Movies.

REC : Launch Record.

□ : Pause.

NETFLIX : Go to Netflix.

prime video : Go to prime video.

🔴 🟢 🟡 🔵 : Corresponds to various colour functions in the menu or teletext.



### Notes:

1. If direct sunlight shine directly on the remote sensor, the remote control's operation may be unstable, and the effective range will be reduced.
2. Do not hit or violently shake the remote control.
3. Never expose the remote control to high temperature or humidity.
4. If the remote is not used for an extended period of time, remove the batteries to prevent damage or injury from possible battery leakage.

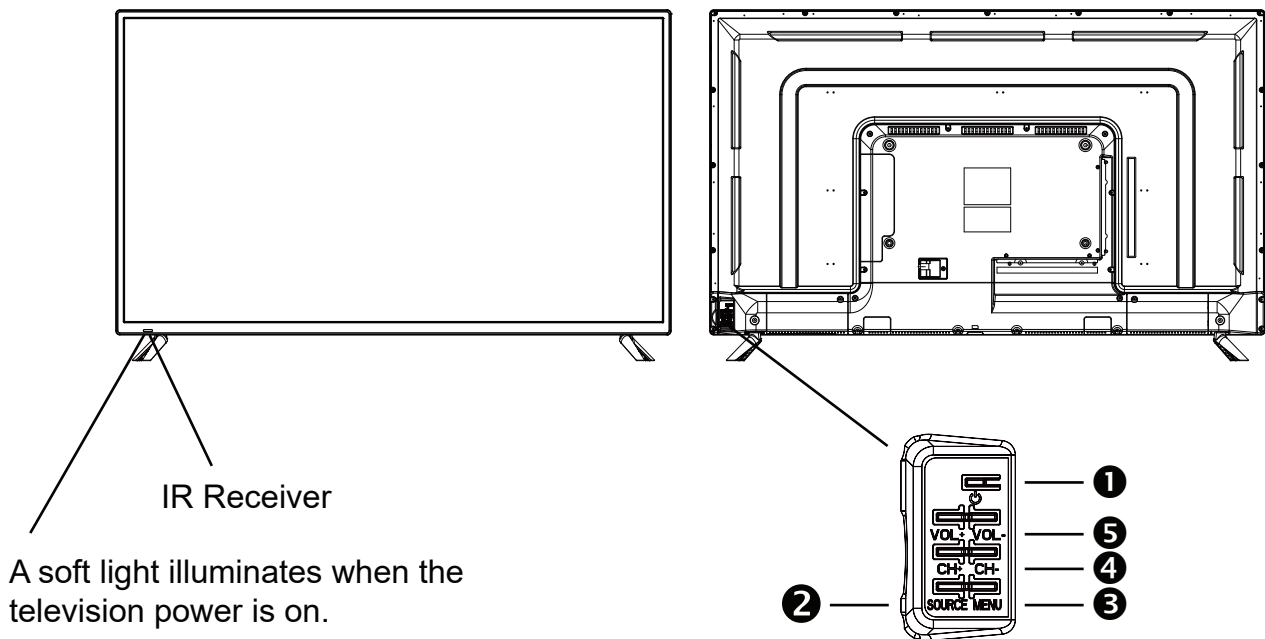

1. **POWER/⏻** - Press the **POWER** button to turn the TV ON/ OFF (standby). The screen image will appear within a few seconds, and the LED will turn on.

2. **INPUT/SOURCE** - After connecting your DVD, cable box, etc. select the appropriate input source to view. Press the **INPUT** button to display the input options. Press the **CH+ / CH-** buttons to highlight the input source and press the **VOL+** button to select.

3. **MENU** - Press the **MENU** button to display. Press **VOL+** to select from the 6 menu options available. Press the **CH+ / CH-** buttons to select a feature from the selected menu then press the **VOL+/VOL-** buttons to adjust the volume settings.

4. **Channel (-CH+)** - Press the **CH- / CH+** buttons to select a channel in the TV mode.

5. **Volume (-VOL+)** - Press the **VOL- / VOL+** buttons to adjust the volume up or down.

# TV Overview

## Rear Panel

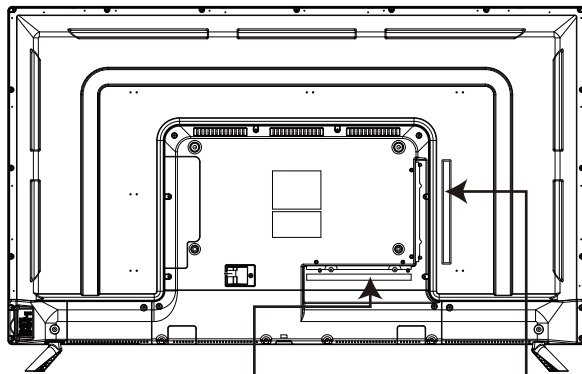

### Wall Mounting

NOTE: :No base, screws provided

It is recommended that you consult a professional before mounting this TV to a wall.

Use VESA 400x200 wall mount hardware.

Wall mount screws size: 4 x (M6 x 10)

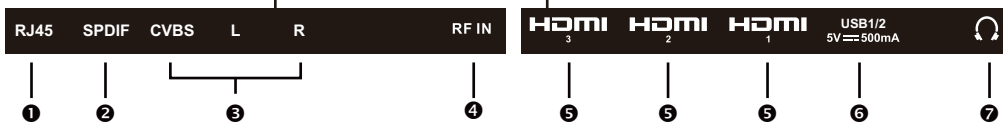

**1. RJ45** - RJ45 plug for connecting to external modem or network access equipment.

**2. SPDIF** - Connect an optional coaxial digital cable (not included) through a compatible amp / receiver to enjoy superior audio sound.

**3. AV** - Connect an external device to the composite VIDEO (V) and AUDIO (L/R) out jacks found on most equipment.

**4. RF Input** - Connect an antenna or cable connection for television reception.  
Note: Use an outdoor antenna, cable or satellite for best reception.

**5. HDMI1/2/3 IN** - To connect to a High Definition (HD) signal output device, such as a set top box, blu ray disc player or AV receiver.

**6. USB Input Port** - Connect to portable USB device such as USB flash/hard drive (max storage capacity 400GB, supports MP3 and JPEG).

**7. Headphone Jack** - Connect a stereo headphone (not included) for private listening.



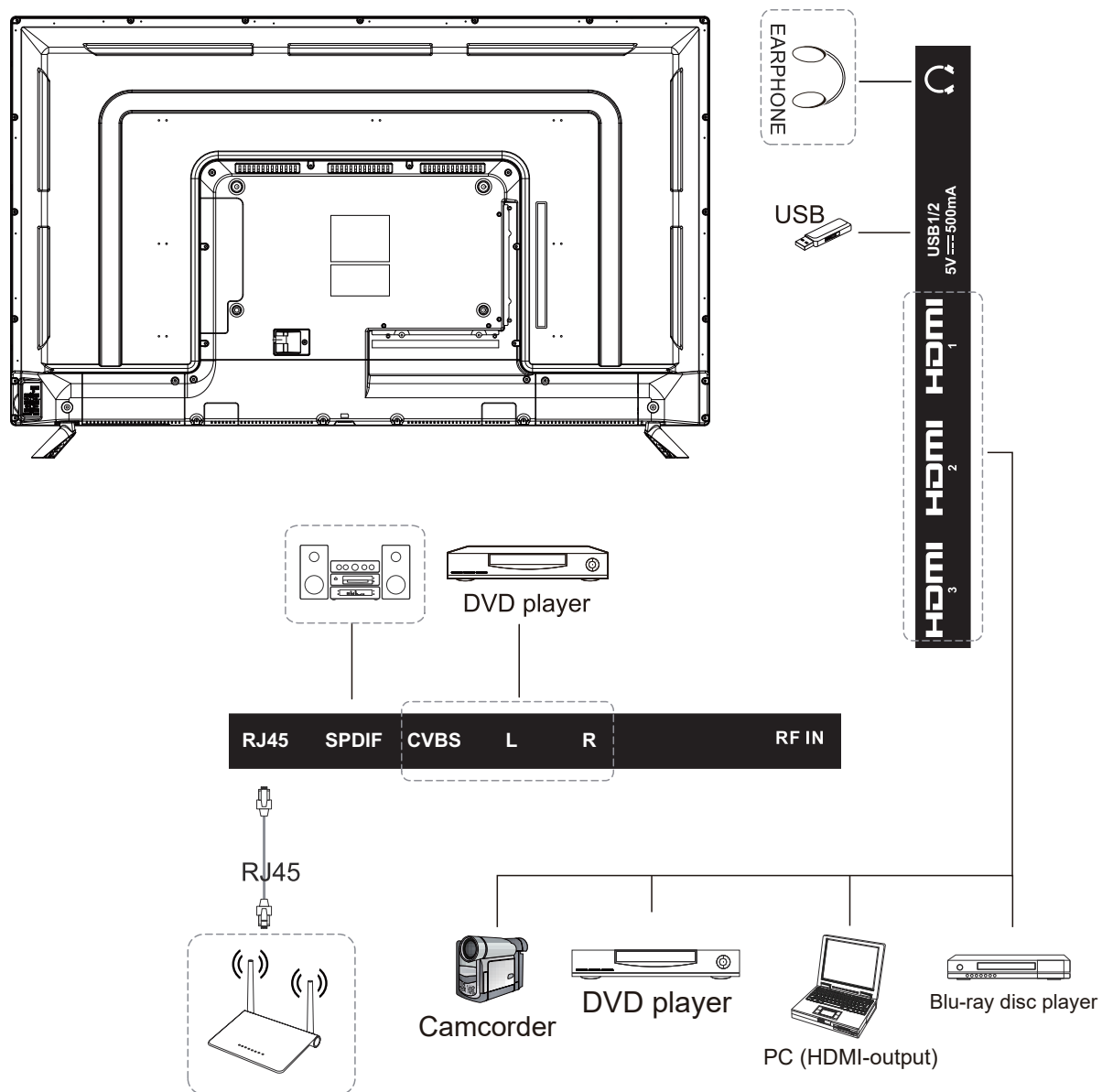

# TV Setting

Software may be updated irregularly, please refer to product's software version.

Press **MENU** button to enter the TV Setting.

Press **▼ / ▲ / ◀ / ▶** button to highlight the desired menu icon , and press **OK** button to select.

## Quick Settings



- ① You can set **Picture Mode**.
- ② You can set **Panel Brightness**.
- ③ You can set **Sound Mode**.
- ④ You can choose **Sound Out**.
- ⑤ You can choose **Sleep Timer**.
- ⑥ You can choose **Screen Off**.
- ⑦ You can set **Game Optimizer**.
- ⑧ You can add/delete the quick setting items or change their order.

# TV Setting

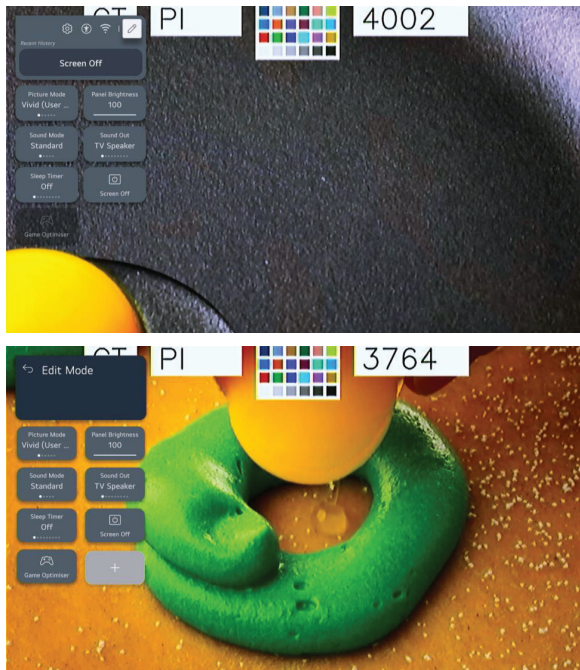

## Picture Mode

Press ▼ / ▲ / ◀ / ▶ button to select the Picture Mode.

Press the <OK> key to enter the sub-menu.

Press ◀ / ▶ button to select Vivid/Standard/Basic/Cinema/Sports/Game Optimiser, and press OK button to setup.

- |                |  |
|----------------|--|
| Vivid          | Sharpens the image by increasing the contrast, brightness and sharpness.                                     |
| Standard       | The default mode, to make users experience high-quality images under normal light.                           |
| Basic          | Basic picture effect.  |
| Cinema         | Is suitable for watching TV or movies in a dark room.  |
| Sports         | Suitable picture for sports games. Sharpens the image of rapid movements such as kicking or throwing a ball. |
| Game Optimiser | Suitable picture for games. Get better game vision   |

# TV Setting

## Panel Brightness

Press ▼ / ▲ / ◀ / ▶ button to select the Panel Brightness.

Press the <OK> key to enter the sub-menu.

Press ▼ / ▲ button to adjust the panel brightness.

## Sound Mode

Press ▼ / ▲ / ◀ / ▶ button to select the Sound Mode.

Press the <OK> key to enter the sub-menu.

Press ◀ / ▶ button to select Standard/ Cinema/ Clear Voice / Sports/ Music, and press OK button to setup.

Standard	Optimises the sound for all types of content.
Cinema	Optimises the sound for cinemas.
Clear Voice	Boosts voice clarity.
Sports	Optimises the sound for sports games.
Music	Enhance the high pitch and reduce the bass.

## Sound Out

Press ▼ / ▲ / ◀ / ▶ button to select the Sound Out.

Press the <OK> key to enter the sub-menu.

Press ◀ / ▶ button to select TV Speaker/ Optical Out Device/ Optical Out Device+TV Speaker/ HDMI (ARC) Device/ Bluetooth Device/ Bluetooth Device +TV Speaker/ Wired Headphones/ Wired Headphones + TV Speaker/ Mobile Device, and press OK button to setup.

## Sleep Timer

Press ▼ / ▲ / ◀ / ▶ button to select the Sleep Timer.

Press the <OK> key to enter the sub-menu.

Press ◀ / ▶ button to select Off/ 10 min(s)/ 20 min(s)/ 30 min(s)/ 1 hour(s)/ 1 hour(s) 30 min(s)/ 2 hour(s)/ 3 hour(s)/ 4 hour(s).

## Screen Off

Press ▼ / ▲ / ◀ / ▶ button to select the Screen Off.

Press the <OK> key to enter the screen off state.

# TV Setting

## Game Optimizer

Press ▼ / ▲ / ◀ / ▶ button to select Game Optimizer.

## Network

If you configure settings for the network, you can use various services such as online contents and applications.

Press ▼ / ▲ / ◀ / ▶ button to select the Network.

Press the <OK> key to enter the sub-menu.

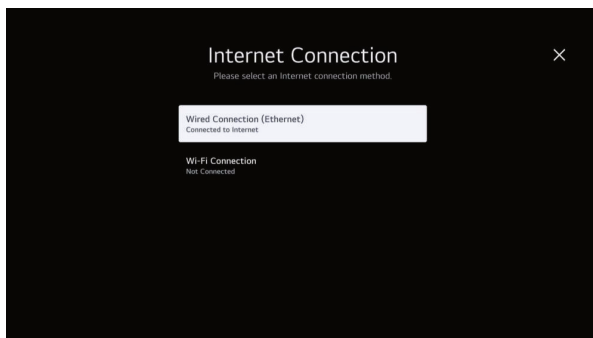
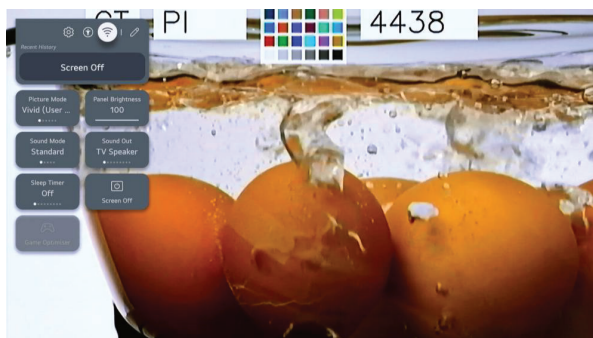

### Wired Connection(Ethernet)

Press ▼ / ▲ button to select Wired Connection(Ethernet). Press **OK** button to enter sub-menu and setup.

# TV Setting

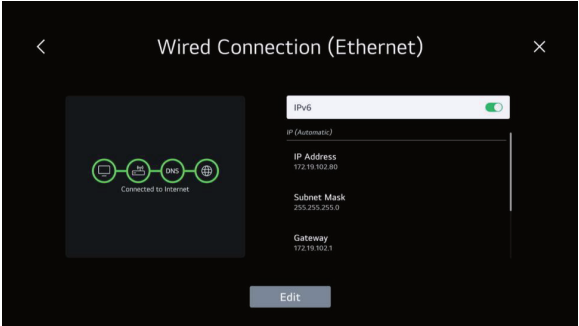

## Wi-Fi Connection

Press ▼ / ▲ button to select Wi-Fi Connection. Press **OK** button to enter sub-menu and setup.



## All Settings

Press ▼ / ▲ / ◀ / ▶ button to select the All Settings.

Press the <OK> key to enter the sub-menu.

Press ▼ / ▲ button to select Picture/Sound/General/Support.

# TV Setting



## Picture

Press ▼ / ▲ button to select Picture. Press **OK** button to enter sub-menu and setup.

(option: Select Mode/Aspect Ratio/Advanced Settings)



### Select Mode

Press ▼ / ▲ button to select the Select Mode.

Press the <OK> key to enter the sub-menu.

Press ▼ / ▲ button to select Vivid/Standard/Basic/Cinema/Sports/Game Optimiser.

### Aspect Ratio

You can change the screen size according to the type of content you are watching.

Press ▼ / ▲ button to select User Selection/ Just Scan.

### User Selection

Press ▼ / ▲ button to select Aspect Ratio.



# TV Setting

(Optional: 16:9/ Original/4:3/ Vertical Zoom/ 4-Way Zoom)

## Just Scan

Press ▼ / ▲ button to select Just Scan.

If you turn this feature **On**, you can view the content in the aspect ratio that is in the broadcast signal or content source. If the edge of the screen is not clean, please turn it **Off**.

## Advanced Settings

Press ▼ / ▲ button to select the Advanced Settings.

Press the <OK> key to enter the sub-menu.

Press ▼ / ▲ button to select Brightness/Color/Clarity/Apply to all inputs/Reset.

## Sound

Press ▼ / ▲ button to select Sound. Press **OK** button to enter sub-menu and setup.

(Optional: Select Mode/ Sound Out/ Advanced Settings)



### Select Mode

Press ▼ / ▲ button to select the Select Mode.

Press the <OK> key to enter the sub-menu.

Press ▼ / ▲ button to select Standard/ Cinema/ Clear Voice / Sports/ Music.

### Sound Out

Press ▼ / ▲ button to select the Sound Out.

Press the <OK> key to enter the sub-menu.

# TV Setting

Press ▼ / ▲ button to select Use TV Speaker/Use Wired Speaker/Use Wireless Speaker/Use External Speakers with TV Speaker.

## Advanced Settings

Press ▼ / ▲ button to select the Advanced Settings.

Press the <OK> key to enter the sub-menu.

Press ▼ / ▲ button to select Balance/ Equalizer/Apply to All Inputs/ Reset/ Installation Type/ Automatic Volume Adjustment/ DTV Audio Setting/ Match Screen and Sound/ Select HDMI Input Audio Format/ Digital Sound Output/ eARC Support.

### Balance

Balanced left and right channels.

Press OK button to select Balance.Press ▼ / ▲button to adjust.

### Equalizer

Press ▼ / ▲ button on to select Equalizer.

Press OK button to enter sub-menu then press ▼ / ▲ ◀ / ▶ button to adjust.

### Apply to All Inputs

Press ▼ / ▲ button on to select Apply to All Inputs.

### Reset

You can reset the sound effect settings.

Press ▼ / ▲ button to select Reset.

### Installation Type

Press ▼ / ▲ button on to select Installation Type.

Press ▼ / ▲ button to select Stand/ Wall-mounted.

### Automatic Volume Adjustment

Press ▼ / ▲ button on to select Auto Volume.Press **OK** button to select On/Off.

### DTV Audio Setting

Press ▼ / ▲ button on to select DTV Audio Setting.

Press ▼ / ▲ button to select MPEG/ Dolby Digital/ Dolby Digital Plus/ HE-AAC/ Auto.

### Match Screen and Sound

Press ▼ / ▲ button on to select Match Screen and Sound.

(Optional: TV Speaker Delay/ Bypass)

# TV Setting

## Select HDMI Input Audio Format

Press ▼ / ▲ button on to select HDMI Input Audio Format.

You can set the audio format for each HDMI input. When the voice delivered through the HDMI port is not synchronized, set it to **PCM**.

## Digital Sound Output

Press ▼ / ▲ button on to select Digital Sound Out.

(Optional: PCM/Auto/Pass Through)

## eARC Support

Press ▼ / ▲ button on to select eARC Support.

## General

Press ▼ / ▲ button to select General. Press **OK** button to enter sub-menu and setup.

(option: Accessibility/ AI Service/ Game Optimiser/ Family Settings/ Programmes/ Network/ External Devices/ System/ Energy Saving)

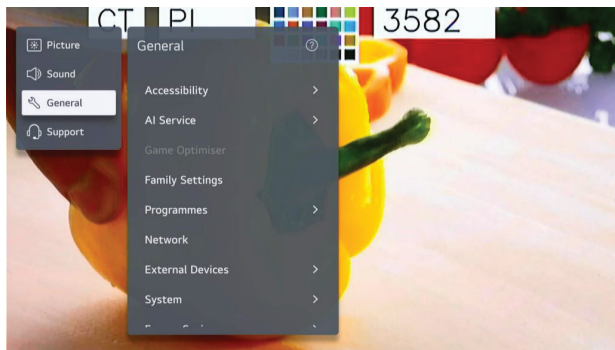

## Accessibility

Press ▼ / ▲ button to select Accessibility. Press **OK** button to enter sub-menu.

(option: Audio Guidance/ Audio Description/ Learn Remote Control/ Enjoy TV Sound Together/ Hard of Hearing/ Subtitles/ High Contrast/ Greyscale/ Invert Colours)

# TV Setting

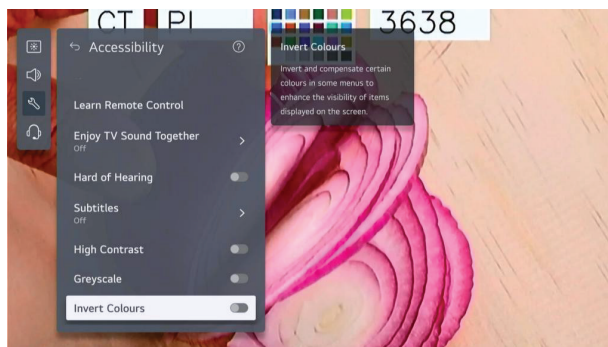
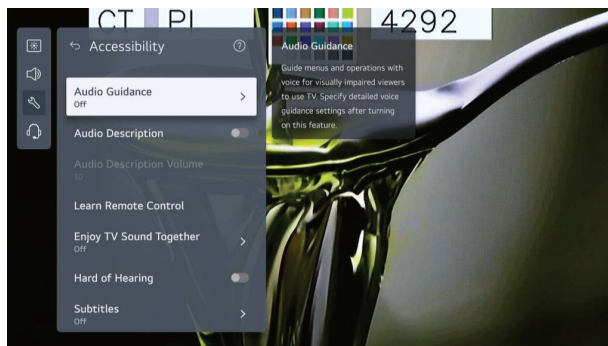

## Audio Guidance

Press ▼ / ▲ button to select Audio Guidance. Press OK button to enter sub-menu.

All the Options are available only when the Audio Guidance select On.

## Audio Description

Press ▼ / ▲ button to select Audio Description. Press OK button to select On/Off.

## Learn Remote Control

Press ▼ / ▲ button to select Learn Remote Control.

## Enjoy TV Sound Together

Press ▼ / ▲ button to select Enjoy TV Sound Together. Press ▼ / ▲ button to select Off/ Bluetooth Device/ HDMI(ARC) Device.

## Hard of Hearing

Press ▼ / ▲ button to select Hard of Hearing. Press OK button to select On/Off.

# TV Setting

## Subtitles

Press ▼ / ▲ button to select Subtitles. Press ▼ / ▲ button to select Subtitle First Choice Language and Subtitle Second Choice Language and press OK button to setup the language.

## High Contrast

Press ▼ / ▲ button to select High Contrast. Press OK button to select On/Off.

## Greyscale

Press ▼ / ▲ button to select Greyscale. Press OK button to select On/Off.

## Invert Colours

Press ▼ / ▲ button to select Invert Colours. Press OK button to select On/Off.

## AI Service

You can enable the recommended services based on the usage history.

Press ▼ / ▲ button to select AI Service. Press OK button to enter sub-menu.

## Game Optimizer

Press ▼ / ▲ button on to select Game Optimizer.

## Family Settings

Press ▼ / ▲ button on to select Family Settings.

Press ◀ / ▶ button to select Usage Limit Setting/ Eye Care Mode/ Volume Limit Mode/ Screen Time Report. Press OK button to enter sub-menu. Press OK button to enable the function.

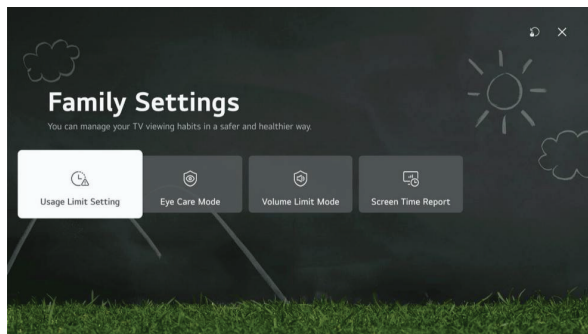

## Programmes

Press ▼ / ▲ button on to select Programmes. Press OK button to enter sub-menu.

(Optional: Programme Tuning & Settings/ Programme Manager/ CI Information/ Copy Programmes/ HbbTV)

# TV Setting

## Network

Press ▼ / ▲ button on to select Network.

## External Devices

Press ▼ / ▲ button on to select External Devices. Press OK button to enter sub-menu.

(Optional: Connect Bluetooth Controller/ HDMI Settings/ Universal Control Settings/ TV On With Mobile/ Delete Connection History)

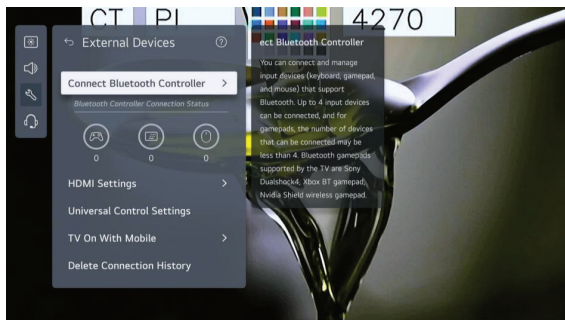

## System

Press ▼ / ▲ button on to select System. Press **OK** button to enter sub-menu and setup.

(option: Language/ Location/ Time & Timer/ Safety/ Additional Settings/ Reset to Initial Settings)

## Language

You can choose the menu language displayed on the screen and the audio language of the digital broadcast.

Press ▼ / ▲ button to select Language. Press OK button to enter sub-menu.

(Optional: Menu Language / Primary Audio Language / Secondary Audio Language/ Keyboard Languages / Primary Teletext Language / Secondary Teletext Language)

Press ▼ / ▲ button to select the menu and setup the language.

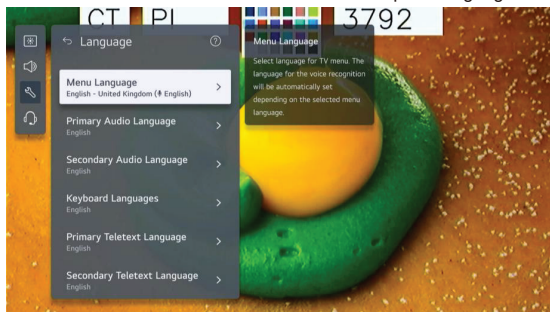

# TV Setting

## Location

You can change the location setting of your Smart TV.

Press ▼ / ▲ button to select Location. Press OK button to enter sub-menu.

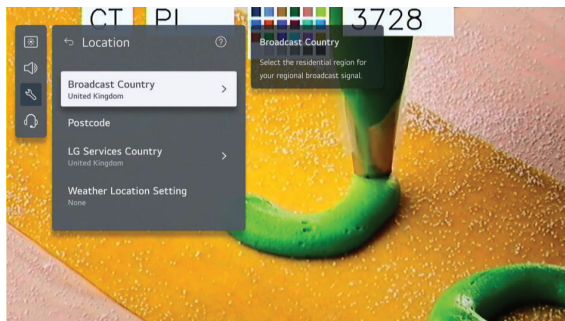

## Broadcast Country

Press ▼ / ▲ button to select Broadcast Country. Press OK button to enter sub-menu.

You can set the broadcast country on your TV.

## Postcode

Press ▼ / ▲ button to select Postcode. Press OK button to enter sub-menu.

This function is used to set the broadcast location of the TV by entering your postcode.

## LG Services Country

Press ▼ / ▲ button to select LG Services Country. Press OK button to enter sub-menu.

If you don't set the Set Automatically, you can select the country manually.

## Weather Location Setting

Press ▼ / ▲ button to select Weather Location Setting. Press OK button to enter sub-menu.

You can set the Weather Location Setting.

## Time & Timer

You can check the time or configure related settings.

Press ▼ / ▲ button to select Time. Press OK button to enter sub-menu.



# TV Setting

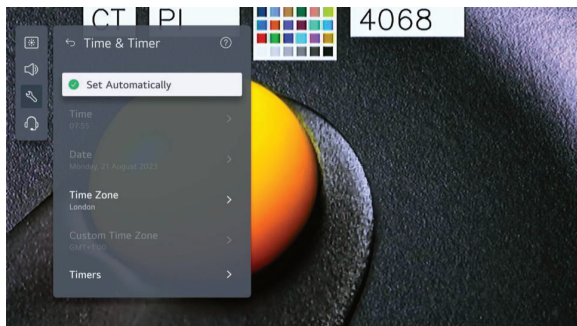

## Set Automatically

The TV time is automatically set to the time of digital broadcasting information sent from the broadcasting station or the time sent from the server.

Press ▼ / ▲ button to select Set Automatically. Press **OK** button to select On/Off.

## Time / Date / Time Zone

You can manually set the time and date if the automatically set current time is incorrect.

Press ▼ / ▲ button to select Set Time / Date / Time Zone. Press **OK** button to select.

## Timers

Press ▼ / ▲ button to select Timers. Press **OK** button to enter sub-menu.

## Safety

Press ▼ / ▲ button to select Safety. Press **OK** button to enter sub-menu.



All the Options are available only when the Safety select On.

The initial password is set as "0000".

Press ▼ / ▲ button to select the option then press **OK** button to setup.

# TV Setting

## Additional Settings

Press ▼ / ▲ button to select Additional Settings. Press OK button to enter sub-menu.

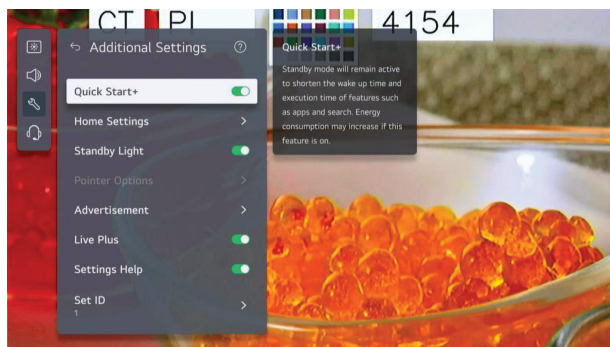

## Reset to Initial Settings

Press ▼ / ▲ button to select Reset to Initial Settings. Press OK button to enter sub-menu.

Return TV to its initial settings. This will revert all settings to their default values.

After reset, the TV will automatically turn off and on.

Note: If Safety is set to On, you should type the password to Reset to Initial Settings.

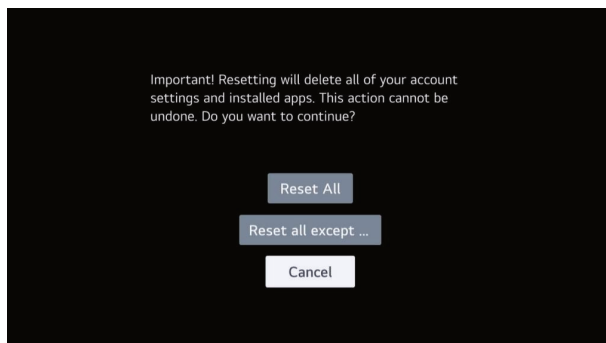

## Energy Saving

Reduces power consumption by adjusting screen brightness.

Press ▼ / ▲ button to select Energy Saving Step/ Auto Power Off/ Screen Off.

# TV Setting

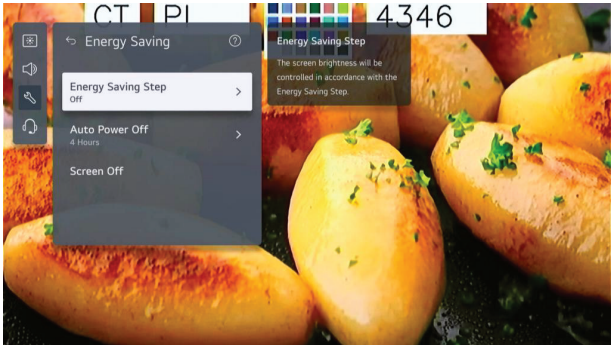

## Energy Saving Step

Press ▼ / ▲ button to Energy Saving Step. Press OK button to enter sub-menu.

(Optional: Off/ Minimum/ Medium/ Maximum)

## Auto Power Off

Press ▼ / ▲ button to select Auto Power Off. Press OK button to enter sub-menu.

(Optional: Off/ 2 Hours/ 4 Hours/ 6 Hours/ 8 Hours)

## Support

Highlight the item and press OK button to enter the sub-menu.

Press ▼ / ▲ button to select Support.

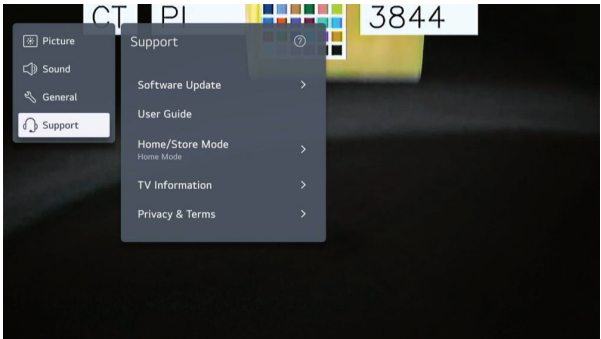

## Software Update

Uses software update to check and obtain the latest version.

# TV Setting

Press ▼ / ▲ button to select Software Update. Press **OK** button to enter sub-menu.

Then press ▼ / ▲ button to select and setup.

## **User Guide**

Press ▼ / ▲ button to select User Guide. Press **OK** button to enter sub-menu.

Then press ▼ / ▲ button to select and setup.

## **Home/Store Mode**

Press ▼ / ▲ button to select Home/Store Mode. Press **OK** button to enter sub-menu.

Then press ▼ / ▲ button to select and setup.

## **TV Information**

Press ▼ / ▲ button to select TV Information.

## **Privacy & Terms**

Press ▼ / ▲ button to select Privacy & Terms. Press **OK** button to enter sub-menu.

Then press ▼ / ▲ button to select and setup.

# Media

Connect a USB storage device (USB HDD, USB stick) to the USB port on the TV to enjoy the content files stored on the USB storage device on your TV.

Press ▼ / ▲ button on to select Photo & Video/Photo/Video/Music.

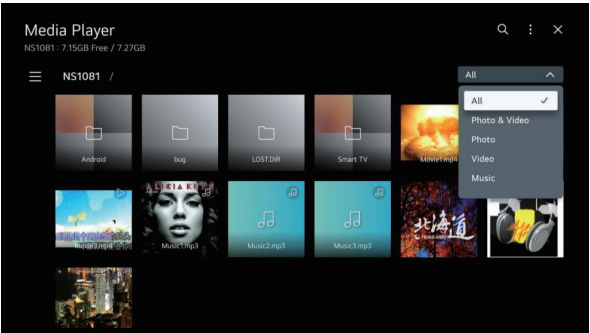

## Photo and Video

You can view photos and videos using the Photo & Video app.

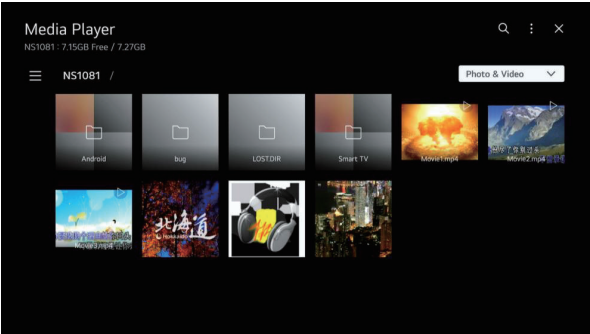

# Media

## Photo

Selecting a photo in the Photo & Video app runs the photo player. You can view your saved photos.

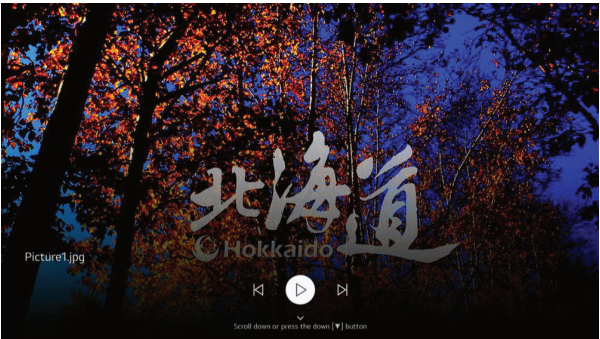

## Video

Selecting a video in the Photo & Video app runs the video player. You can view your saved videos.



# Media

## Music

You can play music conveniently by selecting the music files saved in the Music app or by selecting the music player icon during content playback in apps such as Photo & Video.

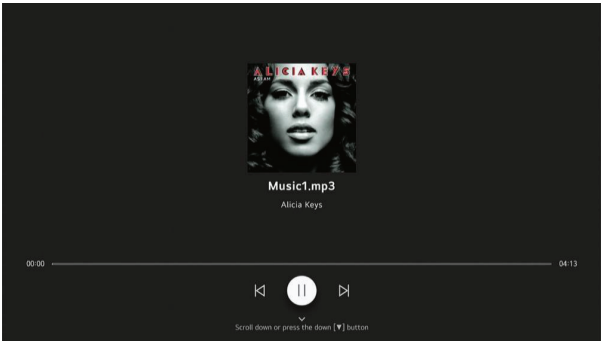

# Specifications

<b>Display</b>	LED
<b>Size (inch)</b>	50" Diagonal
<b>Aspect Ratio</b>	16:9
<b>Digital Compatibility</b>	480i / 480p / 720p /1080i /1080p
<b>Resolution</b>	1920x1080
<b>Brightness (cd/m2)</b>	220
<b>Dynamic Contrast Ratio</b>	3000:1
<b>Vertical Viewing Angle (degrees)</b>	178°
<b>Horizontal Viewing Angle (degrees)</b>	178°
<b>Maximum Colors (millions)</b>	1.07G
<b>Power Consumption</b>	150 W
<b>Audio Power</b>	2 x 8W
<b>Dimension without Stand</b>	44.6" (W) x 26.2" (H) x 3.7" (D)
<b>Weight (may vary <math>\pm</math> 10%)</b>	21 lbs
<b>Input Connections</b>	<div> RJ45 (1)  USB (2)  Optical (1)  Composite Video (1)  CABLE-ANTENNA (1)  HDMI (3)  Earphone (1) </div>



# Troubleshooting

Check for a possible solution to a symptom before contacting a customer service representative.

Symptom	Possible Solutions
No color	<ul style="list-style-type: none"><li>• Check the video installation of your external A / V equipment. See pages 11-12.</li></ul>
Video noise or choppy picture	<ul style="list-style-type: none"><li>• Readjust antenna. Keep TV away from noise sources, neon lights, and microwave appliances.</li></ul>
Cannot use certain functions	<ul style="list-style-type: none"><li>• If the item chosen in a menu is shown in gray text, that item cannot be selected in the current input.</li></ul>
No sound	<ul style="list-style-type: none"><li>• Check that connected audio cables are completely inserted. See pages 11-12.</li><li>• Verify you have selected the correct audio source from your amplifier.</li><li>• Mute function may be enabled, press mute on the remote. See page 8.</li></ul>
Black box on screen	<ul style="list-style-type: none"><li>• The "Text" option is enabled and no text is available.</li><li>• Press the CCD button on the remote control to turn off. See page 8.</li></ul>
No power	<ul style="list-style-type: none"><li>• Batteries in the remote control may need replacing.</li><li>• Re-attach AC plug to wall outlet.</li></ul>
No picture	<ul style="list-style-type: none"><li>• Digital TV channel signal maybe weak, try another channel.</li><li>• Press INPUT button to verify the desired input selected.</li><li>• Re-connect the antenna or cable wiring.</li></ul>
Remote control does not function	<ul style="list-style-type: none"><li>• Replace batteries with new ones.</li><li>• Check that battery polarity is correct.</li><li>• Point remote directly at the TV's IR receiver. See page 10.</li></ul>



The terms HDMI and HDMI High-Definition Multimedia Interface, and the HDMI Logo are trademarks or registered trademarks of HDMI Licensing Administrator, Inc. in the United States and other countries.